

VCM-D1 Single Channel Driver

Features

- The UNIBLITZ[®] VCM-D1 is the optimal driver for the CS, LS, VS, and XRS series shutter devices.
- Normally-open or normally-closed shutter operation.
- Up to 8 units can be controlled independently from one computer serial port. Units can be easily daisy chained with an 810RJ cable (please see “Available Accessories”).
- Exposure determined by external pulse (BNC, TTL) or switch contact closure. Pulsed on/pulsed off exposure control (BNC, TTL) from external trigger pulse or remote actuate cable.
- Selectable pulse energy for operation of the 35, 45, 65 and 90mm shutter types.
- Internal fuse protection for all DC output voltages
- RS-232C input and output connection accessible via dual RJ45 connector. All inputs and AUX output controllable via RS-232 interface.
- 710A shutter interconnect cable included (7-pin WPI female to 5-pin SWC male, 3 meters)
- The key switch on the VCM-D1’s front panel allows the selection of three operating modes:
 - STD:** Standard shutter operation (STD) exposure determined by external pulse source or switch contact closure.
 - A:** Line interrupt (A) with power loss; unit powers down. When power is restored, unit must be manually or remotely reset to resume standard operation.
 - B:** DC interrupt (B) detects break in external switch contact. When continuity is restored, unit must be manually or remotely reset to resume standard operation.
- Electronic Synchronization system can be disabled via rear panel function switch.
- LOCAL/REMOTE switch allows manual operation of the shutter without requiring removal of external input signals.



Fig. 1 VCM-D1 Single Channel Shutter Driver

Available Accessories

- **710R** (BNC male to hand held pushbutton switch)
- **710R/F** (BNC male to foot activated switch)
- **510A** (5-pin SWC male to 5-pin SWC female)
- **810RJ** (8-pin RJ45 male to 8-pin RJ45 male)
- **910RJF** (Adapter, RJ45 to DB-9F)
- **910RJM** (Adapter, RJ45 to DB-9M)

Drawings

Front Panel

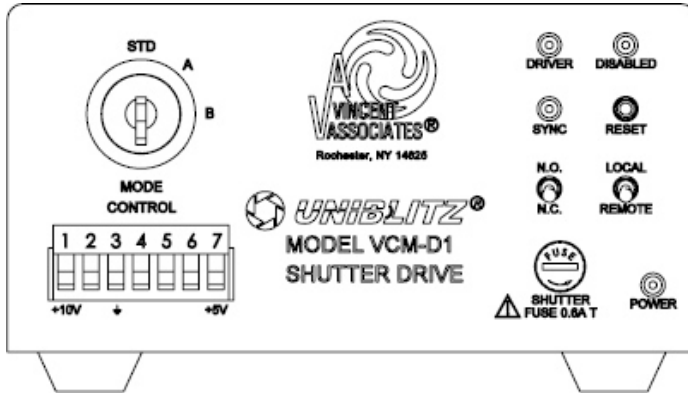

LED indicators reveal shutter status at a glance, while the MODE key switch will set the unit to a specific interrupt mode not allowing an inadvertent change in setting once the key is removed. Additional interrupt functions are available at the MODE CONTROL 7-PIN pluggable connector. The AUX output and +5VDC output are also available at the MODE CONTROL connector.

Rear Panel

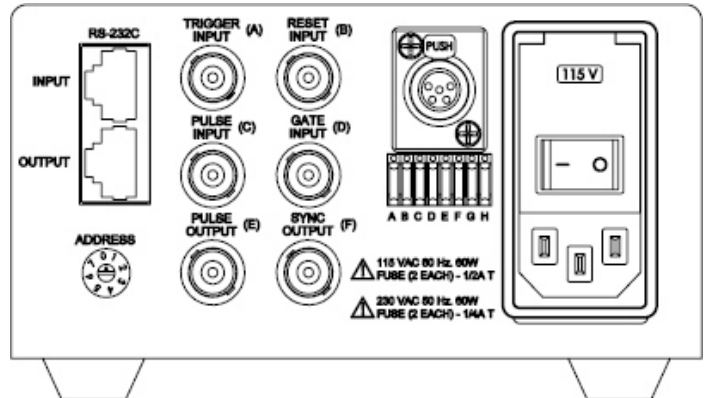

All main input/output functions can be accessed at the VCM-D1 rear panel, including the 115/230VAC input which is manually selectable. BNC connectors allow for quick termination of TTL command signals. Function switches A-F determine the active state of the BNC inputs or outputs (high or low level active). Function switch H selects HIGH/LOW energy level. Function switch G will disable the SYNC output BNC and disable the IR emitter of the synchronization circuit within the shutter used.

Compatibility

The VCM-D1 is compatible with the following UNIBLITZ® shutter devices:

VS	LS	CS	DSS	TS	NS	XRS
VS14	LS2	CS25				XRS6
VS25	LS3	CS35				XRS14
VS35	LS6	CS45				XRS25 ¹
		CS65				
		CS90HS				

Use with shutter devices other than those listed to the left is not recommended. Please contact us for further information.

¹ This device requires two drivers for operation.

Product Options

Part Number: **VCM-D1** 

① ②

② J: For sale in Japan only
▪ Leave blank if not required

Specifications

- Size (HWD) 2.73 x 5.41 x 8.18 inches (69.3 x 137.4 x 207.8 mm)
- Weight 3.5 lbs (1.59kg).
- Power 115/230 VAC, 50-60 Hz, 60 W
- RoHS compliant
- CE/UL/CSA certification

For information regarding applicable intellectual property, please visit www.uniblitz.com/patents.

803 Linden Avenue • Rochester, NY 14625 • 585-385-5930 tel • 800-828-6972 toll-free • 585-385-6004 fax • www.uniblitz.com

Due to our ongoing product development program, Vincent Associates reserves the right to discontinue or change specifications or designs at any time, without incurring any obligations. Teflon is a registered trademark of E.I. DuPont. Drawings shown for illustrative purposes only. Updated 06/13. Specification sheet Ver. 1.1