

### 1 keV to 30 keV

### Medium energy electron beam, High current density

#### FOR USE IN:

MBE RHEED STUDIES  
ELECTRON DIFFRACTION  
SPACE PHYSICS STUDIES  
GAS ELECTRON FLUORESCENCE  
X-RAY GENERATION  
HEATING / MELTING / WELDING  
VACUUM PHYSICS EXPERIMENTS

#### FEATURES / OPTIONS:

NEW MODULAR DESIGN  
INTERNAL ALIGNMENT WHILE OPERATING  
COLLIMATED BEAM  
SPOT SIZE DOWN TO 500  $\mu\text{m}$   
MEDIUM BEAM CURRENTS UP TO 5 mA  
ELECTROSTATIC FOCUSING & DEFLECTION  
UHV COMPATIBLE / BAKEABLE  
COMPUTER / REMOTE CONTROL  
USER-REPLACEABLE FIRING UNITS



EMG-4215A Electron Gun with 4½ inch CF mounting flange

The Kimball Physics EMG-4215 Electron Gun, with its matching EGPS-4215 Power Supply, is a multi-purpose modular Electron Gun with applications in many areas. The EMG-4215/ EGPS-4215 is a complete subsystem ready to attach to a user's vacuum system and turn on. The gun has the capability of producing a collimated, small spot or flood electron beam.

Beam current, beam divergence, and beam energy are all adjustable over wide ranges. The energy can be varied from 1 keV to 30 keV. With the lanthanum hexaboride cathode, the beam current is independently adjustable from 1 nA to 5 mA. The gun can deliver spots down to 500  $\mu\text{m}$ . Rastering is also available as an option.

The modular design of the EMG-4215 allows either the firing unit assembly or the lens assembly to be replaced. The firing unit cartridge (including the cathode, cathode-mount, and Wehnelt aperture) is user-replaceable without removing the entire gun from the vacuum chamber. The anode is also replaceable. The cathode to anode spacing is internally adjustable to vary perveance.

The gun features an adjustable cathode feedthrough assembly that allows the mechanical alignment of the firing unit with respect to the

anode and the column. This alignment can be done in real time while the gun is operating at full voltage with beam on.

UHV technology is used throughout. The gun can be run in vacuums from  $10^{-11}$  torr up to  $10^{-7}$  torr for the standard LaB<sub>6</sub> cathode. The electron gun is bakable to 350°C with cables removed.

Firing unit cartridges are user-replaceable, and used cartridges may be returned to the factory for rebuild. The electron gun itself may also be sent back to the factory for complete disassembly, cleaning, and rebuild of the firing unit assembly (including installation of a new cathode).

The EGPS-4215 Power Supply features a modular design with miniaturized power supply clusters, optically isolated signals, and the new FlexPanel digital interface controller. The included power supplies are Beam Energy, Focus, X,Y Deflection and the floating Source/ECC and Grid supplies. The system includes a separate High Voltage Power Supply connected to and controlled by the EGPS-4215. A rastering option can be provided by an additional separate power supply unit, the Raster Generator Deflection Unit (RGDU).

The new FlexPanel provides a digital display screen and a keypad controller for programming control on the front panel. Rear panel connectors allow remote /computer control and metering of all gun power supplies. An RS-232 serial port and an analog input/output connector are included on standard power supply units. All common computer interface bus types can be accommodated, by use of appropriate digital to analog converters. RS-422/485 conversion is possible.

An optional LabVIEW™ computer program designed for the EMG-4215 is available for remote computer control and metering using National Instrument DAQ boards and SCSI connectors on the EGPS-4215. The program provides a virtual panel of controls and meters on the user's computer screen.



EMG-4215 ELECTRON GUN SPECIFICATIONS	
BEAM ENERGY	1 keV to 30 keV (Independently adjustable)
BEAM CURRENT	1 nA to 5 mA
ENERGY SPREAD	Approx. 0.4 eV cathode thermal spread, calculated
BEAM DIVERGENCE	Collimated beam
SPOT SIZE	500 $\mu$ m to 25 mm
WORKING DISTANCE	Typical: 150 mm. Range: 100 mm to 1000 mm
BEAM DEFLECTION	4 Pole Electrostatic: $\pm 2^\circ$ at 30 keV; scales larger at lower energies
PULSE CAPABILITY (using appropriate pulse generator, not included)	Optional Dual Grid Power Supply: pulse width 2 $\mu$ s to DC, rise/ fall 500 ns, rep rates to 5 kHz (TTL required) Note: with High Current option, Grid may not cut off beam at higher energies
BEAM UNIFORMITY	Gaussian
FIRING UNIT	Customer-replaceable Firing Unit Cartridge includes precision-aligned cathode and Wehnelt (G-1) assembly
CATHODE TYPES	Standard: Lanthanum Hexaboride
INTERNAL GUN ALIGNMENT	Adjustable Feedthrough for mechanical alignment of firing unit while gun is operating
MOUNTING	Flange Multiplexer with a 4 1/2 inch CFF, including both tapped and clear mounting holes
INSERTION LENGTH	Standard: 51 mm
GUN DIMENSIONS	Gun length in vacuum: 51 mm sealing surface to end, 51 mm dia. Outside vacuum: 295.5 mm sealing surface to end of cable
FEEDTHROUGHS	Multipin brazed ceramic, threaded stainless steel shell
CABLES / CONNECTORS	Multiconductor 30 kV high voltage fully ground-shielded cable, 20 kV focus cable, and low voltage deflection cable, with mating aluminum connectors, to connect gun and power supply. Standard lengths: 3 m, Optional: 5 m
MAXIMUM BAKEOUT	350°C with cables removed

EGPS-4215 ELECTRON GUN POWER SUPPLY SPECIFICATIONS	
OUTPUTS	All necessary voltages to drive the EMG-4215 Electron Gun (in combination with H.V. Power Supply)
ENERGY SUPPLY STABILITY	<0.01% per hour with 0.05% rms ripple at full output
BEAM STABILITY	$\pm 0.1\%$ per hour with Emission Current Control or $\pm 10\%$ per hour after warm up without ECC
CONTROLS	FlexPanel controls: Energy, Source, Grid, Focus, X and Y Deflection, Emission Current Control,
METERING	FlexPanel digital meters: Energy, Source Voltage, Source Current, Emission Current, Grid, Focus, X and Y Deflection
COMPUTER/REMOTE CONTROL & METER	Power supplies: 0 to +10 V (-10 V to +10 V, deflection) Metering: 0 to +2 V (-2 V to +2 V, deflection) On/off switches: 0 or +5 V Standard 50-pin connector for analog input/output and RS-232 serial port (RS-422 or RS-485 available, if specified at time of order) Optional: SCSI metering and programming connectors
SOFTWARE	Optional: National Instruments LabVIEW™ file, designed to run with computer DAQ boards NI 6034E and NI 6703
COMPUTER SYSTEM	Optional: Industrial computer system including data acquisition and control hardware DAC.
INPUT	115 VAC switchable to 230 VAC, 50 to 60 Hz single phase, 250 VA
ENVIRONMENT	Temperature: 0 to 40°C, Relative humidity: 0 to 75% RH non condensing, Classified as a pollution degree 2, installation category (overvoltage category) II environment unit
DIMENSIONS (width x height x depth)	Two units, total approx: 17 in. x 12.2 in. x 22 in. excluding handles (425 mm x 310 mm x 560 mm); 19 in. rack mountable

OPTIONAL RGDU-4A RASTER GENERATOR SPECIFICATIONS	
RASTER GENERATOR	10 separate frequency selections for both X and Y (X up to 1000 Hz, Y up to 50 Hz) Variable position offset (centering). Variable window size. All controllable remotely via RS-232, RS-422, RS-485, or analog input.
DIMENSIONS (width x height x depth)	17 in. x 3.5 in. x 22 in. excluding handles (425 mm x 90 mm x 560 mm); 19 in. rack mountable



A typical lab set-up of a complete Kimball Physics system with power supplies, electron gun, and optional computer control system

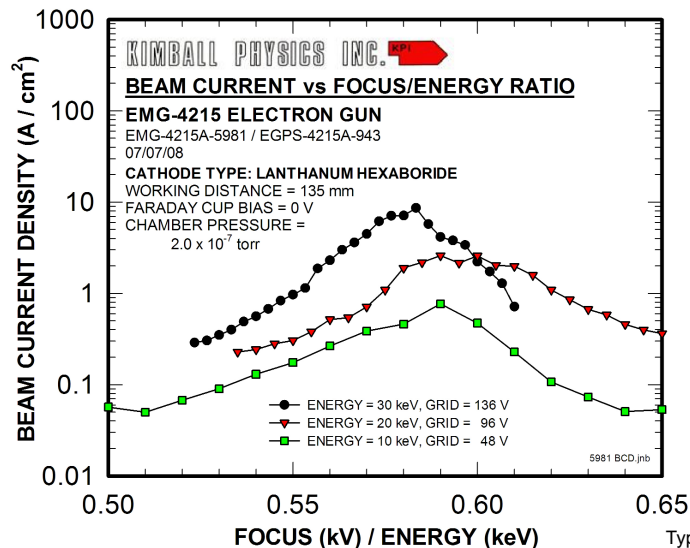
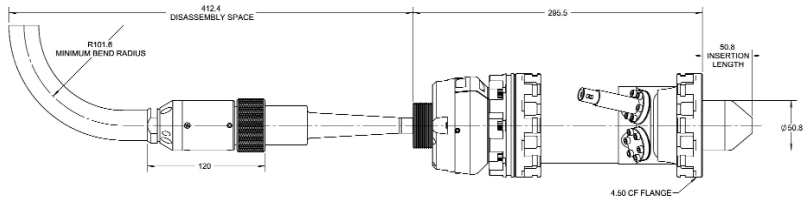

Typical performance; data for guidance only.

